

OFFICIAL COMMUNITY GUIDE

Laurel

NEBRASKA



Welcome to Cedar County!

- ▶ Electric Rates lower than the U.S. average
- ▶ Nearly \$3 million in community investment since 2012
- ▶ Convenient access to major highways

Visit laurelne.com

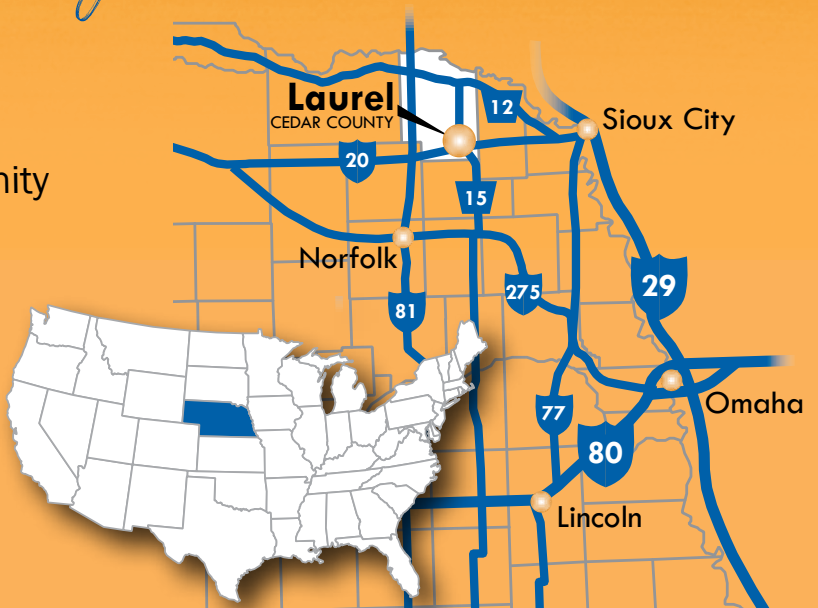

►► Inside the guide

- 3** Economic Development
- 4** Transportation
- 5** Labor
- 7** Communications
- 8** Local Government
- 8** Utilities
- 9** Tax Structure
- 10** Education
- 11** Quality Of Life
- 13** Community Services
- 14** Agriculture
- 15** Climate



The following pages contain basic information about Laurel, Nebraska.

This information was compiled by the Laurel City Office, Laurel Economic Development Office, Cedar County Treasurer Office, Laurel-Concord-Coleridge School and Nebraska Public Power District in order to promote community development and quality of life.

CONTACTS & WEBSITES

Christine Rasmussen

Economic Development Coordinator
City of Laurel
Laurel, Nebraska 68745
Office: 402-256-9614
Email: laureled@abbnebraska.com
laurelne.com

Mark McCoy

City Administrator
City of Laurel
Laurel, Nebraska 68745
Office: 402-256-3112
Email: laurelca@abbnebraska.com
laurelne.com

Rachel Steffen and Max Rasmussen

Laurel Chamber Community Club Co-Chairs
Laurel, Nebraska 68745
Office: 402-256-9614 for info and messages
Email: laureled@abbnebraska.com
laurelne.com

Mary M. Plettner, CEcD

Economic Development Manager
Nebraska Public Power District
Columbus, Nebraska 68602-0499
Office: 402-563-5534
Cell: 402-750-1907
Email: mmplett@nppd.com
sites.nppd.com

laurelne.com



A 12.47 acre lot is ready for industrial development, conveniently located in the northwest part of Laurel.

Economic Development

Laurel is a thriving, progressive community and is known for its continuous economic and community growth since its inception in 1893. Its location in the northeast corner of Nebraska at the intersection of state highways 20 and 15 and the BNSF railway that runs through town make Laurel the ideal location for businesses looking to build, relocate or expand.

Laurel is home to nearly 1,000 active and dedicated citizens who work together to continue the exciting progress our city is known for. The entire community takes great pride in its achievements.

The City of Laurel Economic Development (ED) Office is a part of the City of Laurel. The ED office works under the supervision of the City office and receives direction, feedback and oversight by a seven-member Advisory Council. Funding for this office comes from the City budget and private donations. The City of Laurel is committed to making the town a desirable place to live, work and play by providing community activity facilities, fostering an environment for business opportunities and growth, and acting in a fiscally responsible manner.

In, 2012, a \$1.9 million electrical infrastructure expansion and \$1 million street extension project served as the catalysts for the development of the Laurel Industrial Park. Since then, five new businesses have built facilities in the park. An additional 12.47 acres on the south side of the BNSF Railway across from the Industrial park is zoned for Industrial use and available for new or expanding business.

Downtown Laurel has also seen growth and renewal in both retail businesses and professional services. A group of local investors partnered

with Faith Regional Physicians Services to construct a new downtown medical clinic, which houses Laurel Family Medicine. Many businesses received a new look thanks to Community Development Block Grant (CDBG) Downtown Revitalization Funds and local investment. Downtown property owners leveraged more than \$250,000 in CDBG funds for facade and structural improvements to their buildings. In 2021, the City of Laurel will begin infrastructure improvements in the downtown area, which will include replacement of the streets, sidewalks, storm sewer and lighting for a total project cost of more than \$2.6 million. The construction of the new Laurel Community Center will be a cornerstone in revitalizing Laurel for generations to come and will accentuate Laurel's Downtown Revitalization Project.

The City of Laurel and the Laurel-Concord-Coleridge School District have maintained a partnership through the Community Learning Center to provide a vast amount of library and educational resources to citizens and students. The LCC Fitness Center is a school and public exercise complex that provides exceptional equipment for high school athletes and community members alike.

The ED Office works with enthusiastic community members, business leaders and school administration on many projects, including the Youth Philanthropy Project, which invites the youth ages Kindergarten through 25 years, to take a look at their communities and see what they want to change. Approved projects are given up to \$500 to help make their visions of betterment become reality. Investing in our youth and their communities, will help us all reap the harvest of their return to their communities after college.

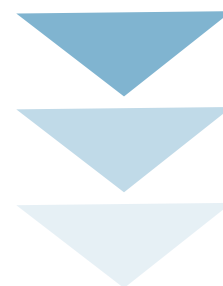

“Laurel is an active and growing community, currently in the process of building a community center, revitalizing Main Street and upgrading school buildings. It’s a great place to grow up or raise a family.

**- Mark Patefield,
Businessowner and
Mayor of Laurel**



Transportation

Location / Highways

Laurel is located in southeast Cedar County, approximately 23 miles southeast of Hartington, the county seat of Cedar County. Nebraska Highway 15 runs through town from north to south and Nebraska Highway 20 runs east of town. Laurel is 42 miles northeast of Norfolk, 40 miles west of Sioux City, IA, 45 miles south of Yankton, SD, and 130 miles northwest of Omaha.

Air

The Wayne Municipal Airport, located 16 miles south of Laurel, has three runways; two lit paved and one grass runway. Paved runways are 3,400'x60' and 4,200'x75'.

Nearest Commercial Air Service:

- Sioux Gateway, Sioux City, Iowa
45 miles, 50 minutes
- Norfolk Regional Airport, Norfolk, Nebraska
45 miles, 55 minutes
- Eppley Airfield, Omaha, Nebraska
122 miles, 2.25 hours
- Lincoln Regional Airport, Lincoln, Nebraska
135 miles, 2.25 hours

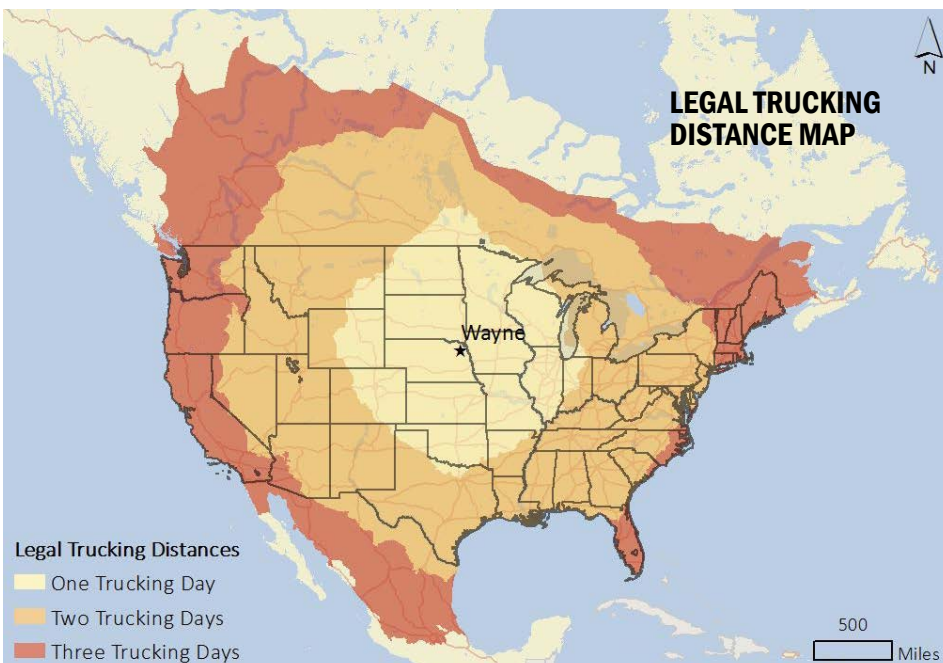
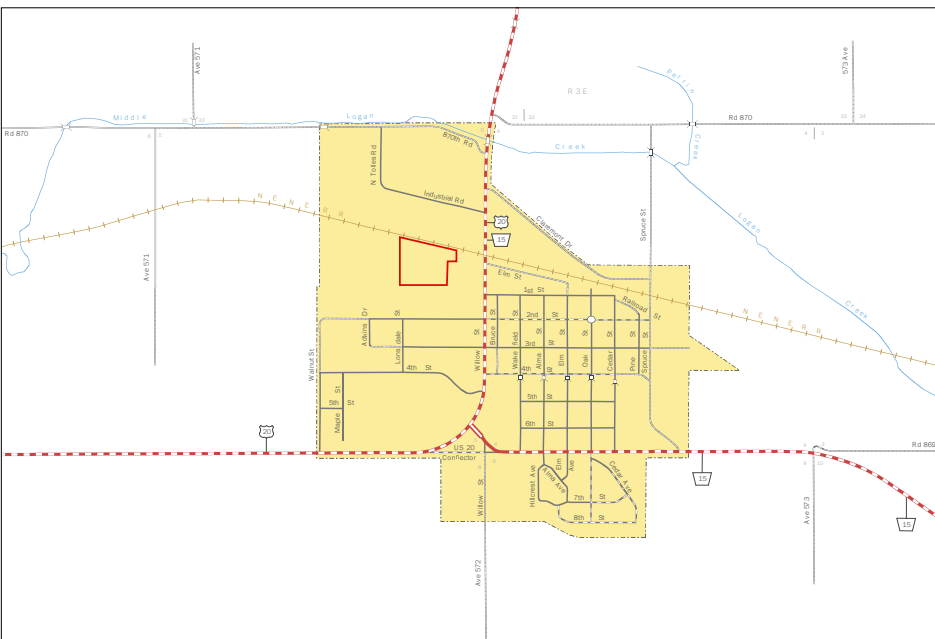

Trucklines

More than 13,500 licensed motor carriers with worldwide connections are based in Nebraska and serve businesses throughout North America. The following trucking map is based on Wayne, Nebraska, 16 miles south of Laurel.

Rail

Laurel is served by the BNSF Railway.

Source: Nebraska Department of Economic Development. Legal Trucking Distance from Wayne, Nebraska. Generated by Andrew Eckerson using ESRI Business Analyst Desktop.

Labor

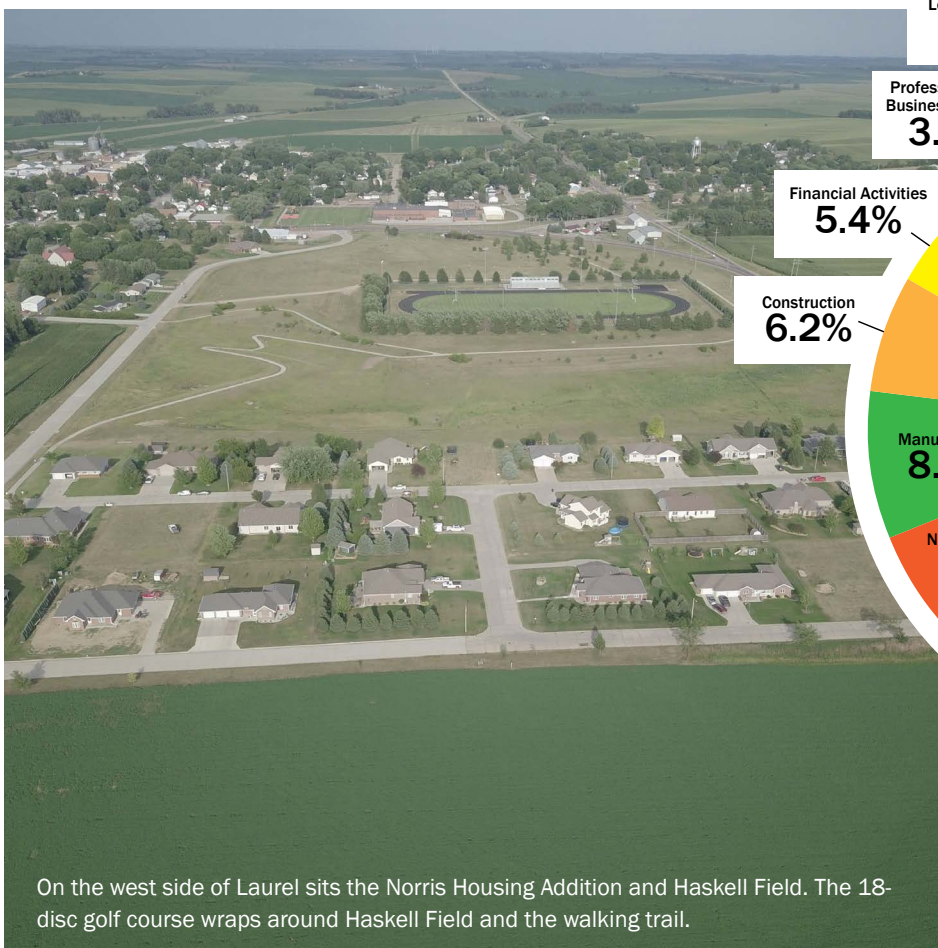

On the west side of Laurel sits the Norris Housing Addition and Haskell Field. The 18-disc golf course wraps around Haskell Field and the walking trail.

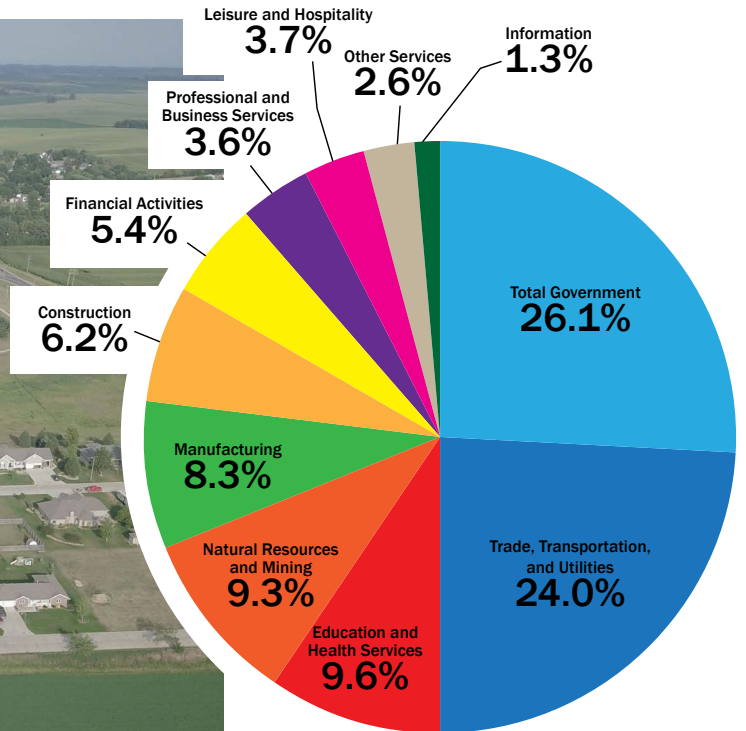

Workforce

The Nebraska Department of Labor serves employers and job seekers across Nebraska through its “One Stop Career Centers” located across the state. Services for employers include employee recruitment and screening, posting job openings, tax credit information, and labor market and labor law information. Job seekers can find a full array of employment and training related services including on site services provided by a network of mandatory Workforce Investment Act partners.

Visit networks.nebraska.gov to learn more about these and other services,

Unionization

Nebraska has a right to work provision in its constitution.

LAUREL'S LEADING EMPLOYERS

EMPLOYERS	PRODUCT OR SERVICE	EMPLOYEES
Laurel-Concord-Coleridge School	Education	92
Hillcrest Care Center	Skilled care facility/nursing home	56
Security Bank	Financial institution	18
Hansen Brothers Parts & Service	Diesel, ag and auto repair; parts sales	18
Gary's Foodtown	Full-service grocery store	17
Laurel ACE Hardware	Tools, hardware, home improvement, lawn and garden & rental equipment	14
Nutrien	Fertilizer and chemical application	16
Main Street Apothecary & Patefield's Old Fashioned Soda Fountain	Pharmacy, soda fountain, gift store	11
Cornermart	Gas station, mini-mart, food	10
Central Valley Ag	Grain purchasing and transportation	9

Average Hourly Earnings for Production Workers, 2018

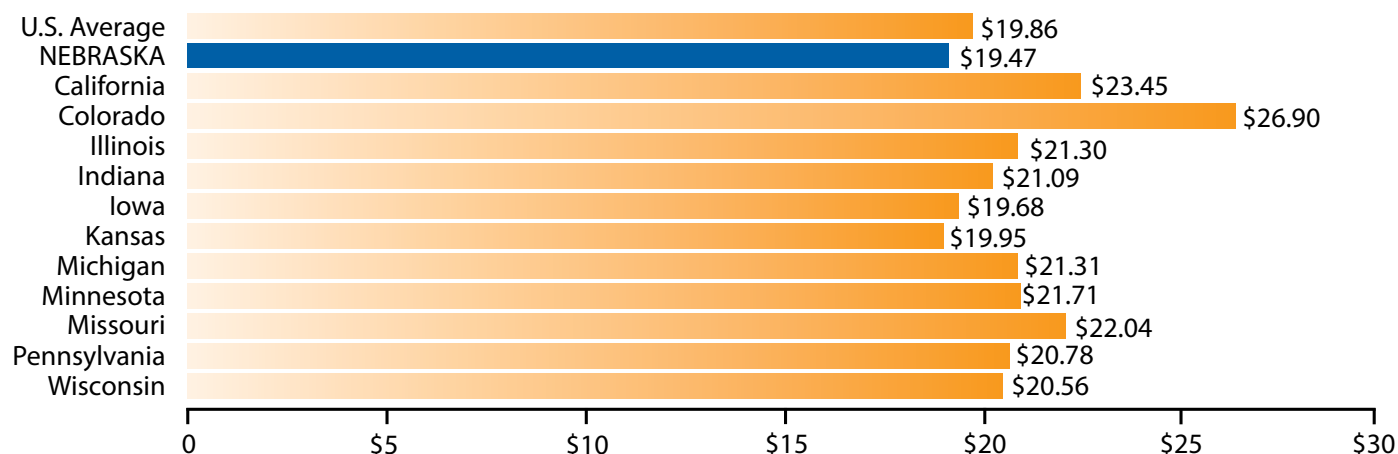

Source: U.S. Bureau of Labor Statistics (www.bls.gov)

Average Employer Tax Amount Per Covered Employee, 2019

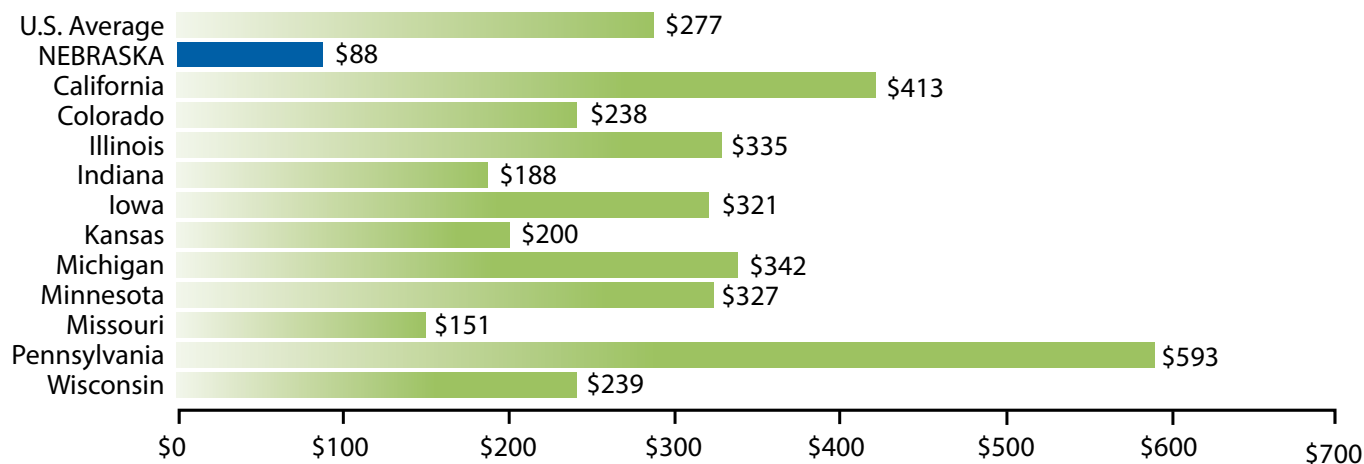

Source: U.S. Department of Labor, Employment and Training Administration.
Average Employer Contribution Rates by State, 2019
<http://workforcesecurity.doleta.gov>



2019 UNEMPLOYMENT RATE

	PERCENT
CEDAR COUNTY	2.5%
NEBRASKA	3.0%
UNITED STATES	3.7 %

Source: U.S. Bureau of Labor Statistics

“There are so many good things going on in Laurel right now...it’s hard not to be excited! The people in Laurel have a reputation for getting things done and it has been a lot of fun to be a part of things that are bigger than what any one person can do on their own.”

- **Christine Rasmussen**
City of Laurel Economic Development Coordinator



Communications

Telecommunications & Internet Providers

American Broadband
 Phone/Internet/Cable TV

Verizon Wireless
 Phone

Dish Network
 Internet/Cable TV

Direct TV
 Internet/Cable TV

Post Office & Package Delivery Service

The U.S. Postal Service in Laurel has one mail receipt and one dispatch daily.

Federal Express, United Parcel Service and the U.S. Postal Service provide package delivery services in the Laurel area.

Newspapers

The Laurel Advocate and Wayne Herald deliver weekly papers.

Radio Stations

Listen in at KTCH 104.9 FM and 1590 AM, The City 98.9 FM, Hot Country 93.1 FM, WNAX The Wolf 104.9 FM and 570 AM, 94 Rock KNEN 94.7 FM, WJAG 780 AM, US92 KUSO 92.7 FM, KEXL Lite Rock 97.5 FM, and KSEZ Z-98 98.7 FM.

ANNUAL AVERAGE 2019 LABOR SUPPLY

*Contiguous Nebraska counties include Knox, Pierce, Wayne and Dixon. Contiguous South Dakota counties include Clay and Yankton.

	CEDAR COUNTY & CONTIGUOUS*	CEDAR COUNTY
NON-FARM WAGE & SALARY WORKERS	32,478	2,645
TOTAL EMPLOYMENT	40,199	4,402
LABOR FORCE POPULATION	41,394	4,515
ADDITIONAL POTENTIAL LABOR SUPPLY		
COMMUTING OUT OF COUNTY (2017)		1,413
UNEMPLOYED		113
TOTAL		1,526

NOTE: Does not include estimated number of homemakers, seasonal and part-time workers, and workers who would shift from low-paying jobs who could be expected to work for industry.

WAGE SAMPLING

Hourly wages rates for various occupations, Northeast Region, Nebraska

JOB TITLE	10TH PERCENTILE	50TH PERCENTILE	90TH PERCENTILE
ACCOUNTANTS AND AUDITORS	17.54	27.47	53.96
COMPUTER PROGRAMMERS	18.41	31.89	50.98
REGISTERED NURSES	24.21	30.18	40.05
RETAIL SALESPERSON	9.88	11.72	16.73
ADMINISTRATIVE ASSISTANTS except legal, medical	10.92	16.03	21.97
CUSTOMER SERVICE REPRESENTATIVES	10.92	15.30	24.35
OFFICES CLERKS, GENERAL	10.07	15.19	22.24
ASSEMBLERS AND FABRICATORS, ALL OTHER	13.01	17.99	23.74
LABORERS AND FREIGHT STOCK, MATERIAL MOVERS, HAND	12.78	17.78	24.47
MACHINISTS	11.49	17.97	27.45
WELDERS, CUTTERS, SOLDERERS AND BRAZERS	14.44	19.33	26.44
WELDING, SOLDERING, AND BRAZING MACHINE SETTERS	16.25	19.87	38.27
HEAVY AND TRACTOR-TRAILER TRUCK DRIVERS	16.22	23.50	32.40
CUTTING, PUNCHING, AND PRESS MACHINE SETTERS/OPERATORS	10.50	17.12	25.55
ELECTRICIANS	17.30	23.87	31.06
TOOLS AND DIE MAKERS	16.80	21.43	30.99

Source: Nebraska Workforce Development, Occupational Employment, Program, Second Quarter 2020

Local Government

Laurel is governed by a mayor and a four-member city council, which are all elected positions.

Cedar County has 21 precincts and is governed by three county commissioners, who are elected by popular vote for four-year terms.

Streets

Laurel has 35.38 miles of streets; 86 percent of the streets are hard-surfaced and 14 percent are gravel.

Fire Protection

Fire protection is provided to the village by a 25 member volunteer fire department. Laurel has one fire station and 81 fire hydrants.

The Laurel Rural Fire Department will build a new Fire Hall and this modern facility will house emergency equipment (fire/ambulance) for Laurel and the surrounding area.

Law Enforcement

The Laurel Police Department employs one full-time police officers and two support personnel.

The Cedar County Sheriff's Department has seven sworn officers and seven support personnel. Regular patrol by the sheriff's department provides protection to existing industries in the area.



Members of the Laurel EMT and Fire Department

2019 CRIME RATES

Per 1,000 Population	VIOLENT CRIMES	PROPERTY CRIMES
NEBRASKA	3.01	20.39
U.S. TOTAL	3.79	21.09

Source: ucr.fbi.gov

For more information on Laurel's local government, visit laurelne.com.

Utilities

Nebraska Highlights

Energy costs are often a considerable part of any business' operational budget. These costs can vary greatly between states, but in Nebraska (the only state in the nation where all electric utilities are publicly owned) electric costs are passed to consumers at low, cost-of-service rates. As a result, the state offers industrial rates well below the national average. Nebraska electric utilities achieve low rates, in part, because they draw from a balanced and efficient "mix" of generation resources.

NPPD has an Economic Development Rate (EDR) for customers with qualifying projects of new or additional electric

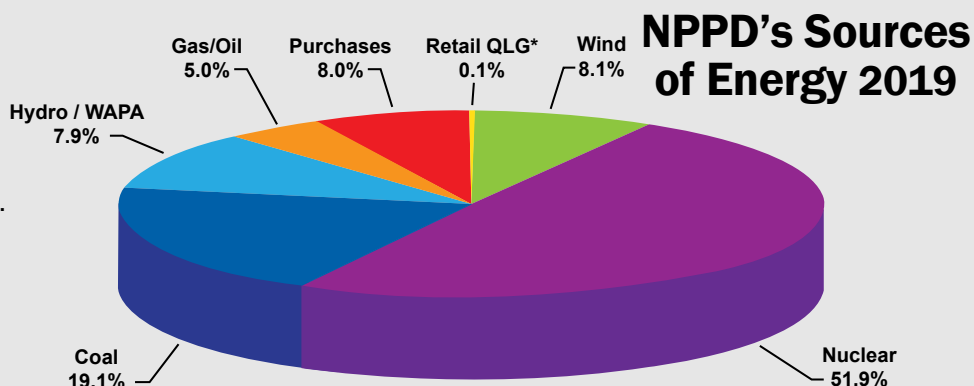

*QLG = Qualifying Local Generation

load. To be eligible for the lower, incentivized EDR, a customer must be served by an NPPD wholesale utility customer or NPPD's Retail Division. The project must add new or additional electric load of at least one megawatt, and have a minimum monthly load factor of 60 percent. The

customer must enter into a written agreement with State of Nebraska or any political subdivision to provide an economic development project pursuant to state or local law and have a written service agreement with NPPD.

Tax Structure

Nebraska Tax Incentives

Nebraska's performance-based tax incentive programs demonstrate the state's commitment to creating a favorable business environment for your business expansion or location. Known as the "Imagine Nebraska

Act," this multi-tiered program provides qualifying businesses with employee payment credits, investment credits, sales and use tax refunds, and personal and property tax exemptions. Qualified companies, large and small can take advantage of these benefits. For more

information on the qualifications and potential benefits available to your company, contact the Nebraska Department of Economic Development 800-426-6505 or visit **opportunity.nebraska.gov**.

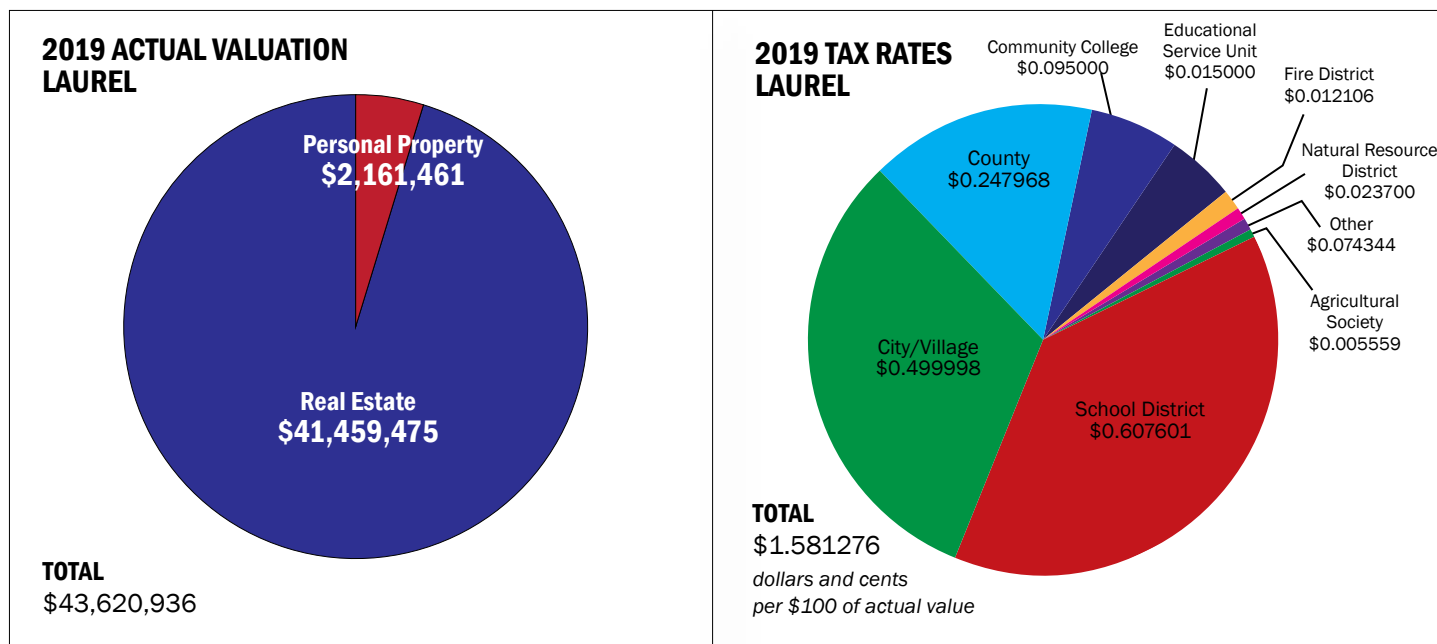

Electricity

The Laurel Utilities Department retails electricity in the city through Cedar Knox Public Power. All power is purchased from Nebraska Public Power District (NPPD). Laurel is served by a city-owned 10MW substation. The substation is fed by a 69,000 kVA transmission line. The substation has an available circuit that can serve a 1,000 kW demand. Prospective customers should contact the City of Laurel at 402-256-3112, laurelne.com, for further information regarding electric rates and services.

Natural Gas

Black Hills Energy is a retail supplier of natural gas in Laurel. For more information, visit blackhillsenergy.com.

Water & Sewerage

The municipal water system in Laurel is supplied by two wells, which have an average depth of 77 and 120 feet. The system, serving the entire village, has a combined pumping capacity of 600 gallons per minute and an overhead storage capacity of 200,000 gallons. The system has a maximum capacity of 1,064,000 gallons per day.

Laurel has a municipal sanitary sewerage system and a partial storm sewer system. The activated sludge treatment plant has a daily capacity of 300,000 gallons.

Visit laurelne.com for more information regarding water and sewerage.

Waste Removal & Recycling

The City of Laurel and Gil Hauling provide solid waste disposal. Contact the City office for rates at 402-256-3112. Laurel Regional Recycling accepts: paper, cardboard, magazines, newspaper, plastic, steel and aluminum.

Education



The Laurel-Concord-Coleridge boys basketball team captured the Nebraska Class D-1 state championship in 2020.

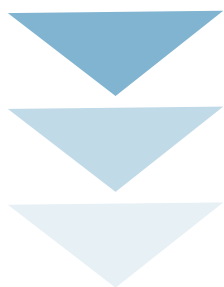

“It takes a community-wide effort to build a future, and Laurel-Concord-Coleridge School has the local partnerships to make that happen. Our drive and commitment to help all students prepare for success in college, their careers, and in life, is second to none. LCC is the place to be!

- Jeremy Christiansen,
Superintendent of Laurel-Concord-Coleridge School

Laurel-Concord-Coleridge School District

Laurel-Concord-Coleridge School District in Cedar, Dixon and Wayne counties covers approximately 275 square miles and has a 2019-20 actual valuation of \$979,854,085 with an actual valuation per student of \$2,182,303.

Bus services are provided between the communities. This Class 3 school is accredited by the Nebraska Department of Education/Cognia. For more information, visit lccschool.org.

Educational Service Unit

Educational Service Unit #1 (ESU), headquartered in Wakefield, serves six counties including Cedar, Dakota, Dixon, Knox, Thurston and Wayne. For more information regarding services, visit esu1.org.

2018-19 ACT SCORES

	COMPOSITE
LAUREL-CONCORD-COLERIDGE HIGH SCHOOL	21.5
NEBRASKA	20.0
NATIONAL	20.7

Source: ACT, Inc.

Higher Education

Laurel is close to both Wayne State College and Northeast Community College. Wayne State College is located in Wayne, 16 miles south of Laurel, and is a thriving public college offering both undergraduate and graduate programs. Located 42 miles to the south is Northeast Community College in Norfolk, which offers more than 130 programs and concentrations.

An abundance of public colleges and universities are available in Nebraska. There are also a number of community colleges as well as private colleges and trade schools. A large number of degree programs are available and some institutions offer courses and workshops specially tailored to meet specific training needs of industry, education, and business.

LAUREL-CONCORD-COLERIDGE SCHOOL

	STUDENTS	TEACHER/PUPIL RATIO	COMPUTER/PUPIL RATIO
ELEMENTARY (PRE-K-4), LAUREL	185	13:1	1:1
MIDDLE SCHOOL (5-8), COLERIDGE	146	13:1	1:1
HIGH SCHOOL (9-12), LAUREL	118	8:1	1:1

Source: Nebraska Department of Education. 2019-20



LCC Fitness Center is a school and public exercise complex that provides exceptional equipment for high school athletes and community members alike.



Laurel provides access to top-notch health services, including Family 1st Dental, located in the revitalized downtown area.

Quality of Life

Hospital

The Providence Medical Center, located 16 miles south in Wayne, is a 25 bed, not-for-profit acute care hospital. Providence Medical Center offers a variety of general and outpatient services such as cardiology, behavioral health. For more information, visit providencemedical.com.

Clinic

Faith Regional Physician Services family medicine team cares for people of all ages, including newborns through seniors. The clinic sees patients for pediatric and well-child care, adult preventative care, acute illness, chronic disease management, immunizations, school and sports physicals, lab and x-ray. The clinic is staffed by two physicians.

Rescue Squad

The Laurel rescue squad is a volunteer service managed by the City of Laurel. The service has two fully stocked advance life support ambulances. The squad has eight emergency medical technicians and nine first responders.

Nursing Homes & Assisted Living

Hillcrest Care and Assisted Living is a 36-bed skilled nursing care facility and a 14-bed Medicaid certified assisted living facility. Services provided include meals, nursing supervision, medication assistance, therapy services, transportation and activities.

Low Cost / Retirement Housing

Hillcrest Colonial Manor/Laurel Elderly Housing is a 16-unit affordable housing project that is community-owned and managed by the Hillcrest Colonial Manor Board of Directors. Applicants must meet income qualifications, citizenship status and pass criminal background checks. Electricity, gas, sewer and garbage is all included in the rent payment. Apartments come with range, refrigerator and window air conditioner. Laundry facilities are located in the community building. Snow removal and lawn mowing are also provided.



A.C. Chiropractic & Wellness office (pictured) and Providence Physical Therapy clinic provide quality care for Laurel residents.



Cedar View Golf Course is Laurel's 9-hole golf course. The clubhouse, pictured, provides a picturesque view.

Churches (Denomination)

- Catholic
- Lutheran
- Methodist
- Presbyterian

Library

The City of Laurel and the Laurel-Concord-Coleridge School District have a unique partnership through the Community Learning Center, which provides a vast amount of educational resources to citizens and students.

The public library shares space with the High School/Elementary library. There is a separation of public and school library, yet there is a fluency between the two areas. The City Library Board works closely with the LCC School Administration involving the day-to-day operation of the facility.

Books, audio books, and many other types of items are available for check out. Also offered are e-books, public computers, Wi-Fi, children's programming, adult education, copy machines, inter-library loans, and laminating. Learn more at lclearningcenter.org.

Recreation

There are three parks in Laurel covering 11 acres. The three parks located in Laurel have playground equipment for all ages.

The City Park has a variety of play equipment, covered shelter picnic area with picnic tables, City-maintained bathrooms and camping pads on the south side of the park.

Lions Club Park is home to the Laurel Swimming Pool, and has covered shelter picnic areas with picnic tables, two playsets for different ages, and a basketball court.

The LCC School playground is the only park area that has a fenced-in area. It has two playsets to accommodate different ages, a set of swings and a basketball court.

Laurel also has a walking trail, that includes newly added workout equipment. The walking trail begins at the LCC School playground.

Laurel has a beautiful nine-hole golf course with a Clubhouse, an 18-basket disc-golf course located around the Haskell Football field, and youth recreational sports that includes seasonal football, volleyball, basketball, soccer, softball and baseball.

Financial Institutions

- Security Bank
- Citizen's State Bank

Housing

Residential lots for new housing construction are available in the Norris and Galvin Additions on the west side of Laurel. The City of Laurel also recently acquired 110 acres on the southeast area of Laurel, adjoining the City limits for future residential development.

One new home was constructed in the past three years and it is estimated two will be built in 2020. The cost of new home construction averages \$200 per square foot.

More information about housing can be found at laurelne.com.



The Community Learning Center is a unique partnership between the school and the community and provides many resources.



A pool party is just one of the many fun activities at Laurel Ag Days.

Public Transportation

The Cedar County Transit is available for transportation for everyone in Cedar County for a small fee. The service provides handicap accessible vans with a wheel-chair ramp for those in need. Cedar County Transit operates Monday through Friday, 8 a.m. to 5 p.m. Call 402-640-6147 to schedule a ride.

Community Services

With a business climate full of opportunity, Laurel continues to expand its retail choices and offers many services to its residents. It offers an ideal blend of small town living with large city amenities. The residents of Laurel have combined talent and a strong work ethic to create an ideal setting in which to work and live.

Ag Commodities	10	Electrical	2	Newspaper	1
Ag Equipment & Repair	3	Exterminator	1	Nursing Home	1
Antiques	1	Family Medicine	1	Paint Service	1
Appliances	2	Farm Suppliers	4	Pharmacy	1
Assisted Living	1	Financial Services	1	Physical Therapy	1
Attorney	2	Flower Shop	1	Printing	2
Automotive	4	Funeral Home	1	Publishing	1
Automotive Repair	4	Gas Station	2	Real Estate	2
Banking	2	Gift Shop	3	Restaurant	3
Beauty Salon	4	Grocery & Food Stores	2	Senior Center	1
Catering	1	Hardware	1	Swimming Pool	1
Child Care Providers	6	Insurance	4	Telecommunications	4
Chiropractor	1	Lawn Service	1	Trucking	1
Construction	7	Library/Learning Center	1	Veterinarian	2
Country Club	1	Lodging	2	Vets Club	1
Dental	1	Massage & Accupuncture	2	Welding	2
Discount Store	1	Meat Processing	2		
Document Shredding	1	Nail Salon	1		
Dry Cleaner	2				



Hillcrest Colonial Manor provides affordable housing for those 55+.

EVENTS

Easter Egg Hunt • Spring

The annual Easter Egg Hunt is fun for all ages. Usually held the Saturday morning of Easter weekend, the event is hosted by the Laurel Chamber Community Club in the City Park. Many prizes are donated by local businesses.

Laurel Ag Days • June

Laurel Ag Days is held annually on Father's Day weekend and includes a pool party, BBQ, Fun Run, inflatable games in the park, a street dance, community parade, and the Alumni banquet held at the high school.

Cruise Night • August

Cruise Night and the Football Tailgate fundraiser is held in August with the proceeds of the Tailgate being donated to LCC School District.

Night of Lights • December

The Laurel Chamber added Night of Lights to the community calendar in 2009. The event is a fun night of local shopping, pictures with Santa, kids activities and more.

Nebraska's Rank Among States

1ST	Beef and veal exports, 2018
	Commercial cattle slaughter, 2019
	Great Northern bean production, 2019
	Great Northern Beans, 2018
2ND	Popcorn production, 2017
	All cattle and calves, Jan. 2020
	All cattle on feed, Jan. 2020
	Commercial red meat production, 2019
	Ethanol production, Jan. 2019
	Pinto bean production, 2019
	Proso millet production, 2019
	Light red kidney bean production, 2019
3RD	Bison, 2017
	Corn for grain production, 2019
	Corn exports, 2018
	Cash receipts from all livestock and products, 2018
4TH	Beef cows, Jan. 2020
	Total animal products exports, 2018
	Soybean production, 2019
	All dry edible bean production, 2019
	Cash receipts from all farm commodities, 2018
	Land in farms and ranches, 2018
5TH	Soybean exports, 2018
	Alfalfa hay production, 2019
	Alfalfa Hay, 2018
	Harvested acres of principal crops, 2019
	Cash receipts from all crops, 2018
6TH	Agricultural exports, 2018
	All hogs and pigs on farms, Dec. 2019
	Commercial hog slaughter, 2019
	All hay production, 2019
	Grain sorghum production, 2019
7TH	Sugar beet production, 2019
	Sunflower production, 2019
	Pork exports, 2018
8TH	Winter wheat production, 2019

Source: Nebraska Department of Agriculture - USDA, NASS, NFO, and NBA



Agriculture

In 2017 Nebraska ranked first among the states in beef and beef product exports; third in corn exports and cash receipts from all livestock and products. Nebraska's farms and ranches utilized 45.2 million acres or 92 percent of the state's total land area. Cash receipts from farm markets in 2018 contributed more than

\$21.0 billion to the state's economy and 5.7 percent of the U.S. total. Food processing is the state's largest manufacturing sector and foreign markets are important for many of the state's manufacturers.

Sources: Nebraska Agriculture Rankings - USDA ERS, USDA, NASS; Food Processing Status - Bureau of Labor Statistics, Quarterly Census of Employment and Wages

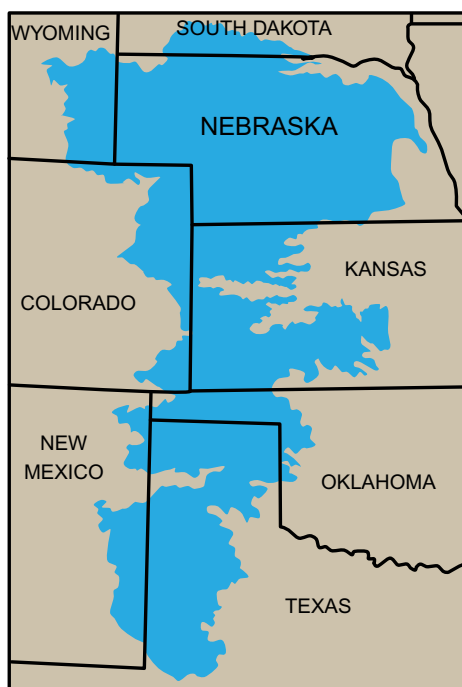

The **Ogallala Aquifer** underlies 174,000 square miles in parts of eight states. The Ogallala Aquifer within Nebraska contains approximately 65 percent of the water storage in the entire aquifer. With the implementation of more efficient irrigation systems and other water management measures, the Ogallala Aquifer will remain a valuable resource in Nebraska.

Nebraska's Natural Resource Districts (NRDs) have responsibility for managing groundwater resources. The Nebraska Department of Natural Resources maintains responsibility for administration of surface water rights. In locations where groundwater and surface water are connected, the responsibility is shared among the NRDs and the state for achieving a sustainable balance between water supplies and water use.



Cedar County ranked in the top ten each of the past five years in alfalfa hay and in the top eight in all of the past five years in soybeans. Cedar County also ranked in the top ten two of the past five years in corn production.

Source: National Agricultural Statistics Service



The 110-car BNSF Central Valley Ag Cooperative shuttle loader facility consists of 1.6 million bushels of upright bin space and 1-million-bushel bunker space as well as a loop track for rail loading.

2017 STATISTICS

	CEDAR COUNTY	NEBRASKA
NUMBER OF FARMS	784	46,332
LAND IN FARMS acres	473,500	44,986,821
AVERAGE SIZE OF FARMS acres	604	971
MARKET VALUE per year	\$539,617	\$474,476
MARKET VALUE OF AGRICULTURAL PRODUCTS SOLD	\$423,060,000	\$21,983,430,000
TOTAL ACRES IRRIGATED	163,240	8,588,389
PERCENT OF FARMLAND IRRIGATED	34.5%	19.1%

Source: 2017 Census of Agriculture

PRODUCTION OF LEADING CROPS

5 year average - 2015-2019

	CEDAR COUNTY	NEBRASKA
CORN FOR GRAIN bushels	35,171,500	1,731,290,000
HAY, ALFALFA tons (2014-2018)	96,200	3,418,400
SOYBEANS bushels	7,279,400	310,639,000

Source: 2017 Census of Agriculture

AVERAGE LIVESTOCK POPULATION

5 year average - 2015-2019

	CEDAR COUNTY	NEBRASKA
ALL CATTLE	113,000	33,300,000

Source: National Agricultural Statistics Service

Climate

Nebraska has a continental climate, with hot summers and cold winters. Temperatures are highly variable from season to season and year to year.

Precipitation is also variable and ranges from an annual average of 15–20 inches in the west to 30–35 inches in southeast Nebraska.

The growing season in Nebraska fluctuates in length, but on average it ranges from 120 days in the extreme northwest to 170 days in the southeast.

For more information regarding Nebraska's climate, visit High Plains Climate Center, University of Nebraska-Lincoln at hprcc.unl.edu.

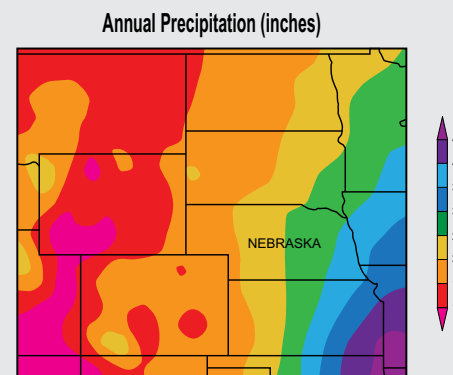



“Laurel is constantly evolving to keep up with the needs of the community I’m beyond excited to see new developments in the infrastructure and opportunities that are available.”

– Melissa Graham, Owner of Missa Sue’s Curly Q’s

Nebraska Public Power District (NPPD), Nebraska’s largest electric utility, assists in economic development for the areas it serves. For more information on NPPD’s economic development assistance, contact Economic Development Department, 1414 15th Street, PO Box 499, Columbus, Nebraska 68602-0499, (877) 275-6773, Ext. 5534, email: econdev@nppd.com, or visit our website at sites.nppd.com.

© Nebraska Public Power District, October 2020

93176c



Nebraska Public Power District
Always there when you need us

nppd.com